

CUSTOMER: **INGERSOL MACHINE** CUSTOMER ORDER REF: ***33800-00 INGERSOL MACHINE**
 DISTRIBUTOR: **REDEX ORDER REF: 218385**
 DESIGNATION: **KRP0+M.10.1.143H.V1.22/32** SERIAL NUMBER: **908553**
 CODE: **RX135990-03** MOTOR FLANGE CODE: **RX128707-02**

EXTERNAL DIMENSIONS & INTERFACES: SN: **908553**

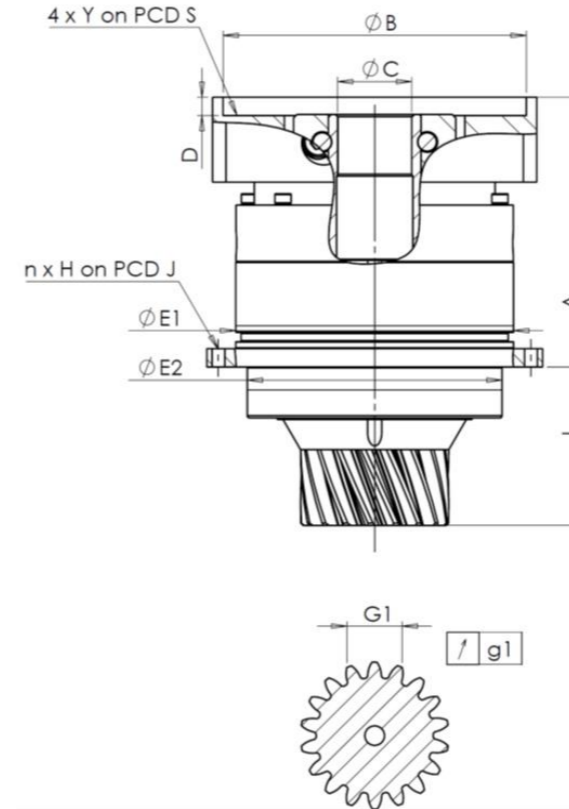

General tolerance: Js13 *Cmm* Automatic / manual coordinate-measuring machine μm Micrometer *Cr* Calliper rule *Di* Dial indicator *Pg* Plug gauge

For the installation, please refer to User Manual KRP (182/008)

SPECIFIC REMARKS:

HOUSING					OUTPUT PINION				MOTOR FLANGE				
requirement		measure			requirement		measure		requirement		measure		
G2430					G1452								
Ø	E1	120h7 ⁰ _{-0,035}	μm	119,99	Span dimension over 3 teeth				Ø	B	111	μm	111
Ø	E2	110h7 ⁰ _{-0,035}	μm	109,98	G1	23,466 ^{-0,071} _{-0,082}	<i>Cmm</i>	23,39	Ø	C	24 ^{+0,041} _{+0,02}	μm	24,03
n x H on PCD J		8Ø5,5 on PCD 135	<i>Cr</i>	8Ø5,5 on PCD 135	g1	0,021	<i>Di</i>	0,008	Ø	D	8	<i>Cr</i>	8,53
					No-load input torque				Ø	S1	130	<i>Cr</i>	130
A		117,5	μm	117,73	Line 1		0,2 Nm		Ø	Y1	M8	<i>Pg</i>	M8
L		69	μm	69,36					Noise level				

	Line	Stiffness
Torsional stiffness (Nm/arcmin)	1	40
Radial stiffness (N/ μm)	1	160

1600 rpm input (dB(A))	66,5
------------------------	------

Date: **22/04/2024**

Visa: **C DE MIRANDA**

Version: **A**

Product images are for illustrative purposes only.