

CUSTOMER: **INGERSOL MACHINE** CUSTOMER ORDER REF: ***33800-00 INGERSOL MACHINE**
 DISTRIBUTOR: **REDEX ORDER REF: 218385**
 DESIGNATION: **KRP0+M.10.1.143H.V1.22/32** SERIAL NUMBER: **908552**
 CODE: **RX135990-03** MOTOR FLANGE CODE: **RX128707-02**

EXTERNAL DIMENSIONS & INTERFACES: SN: **908552**

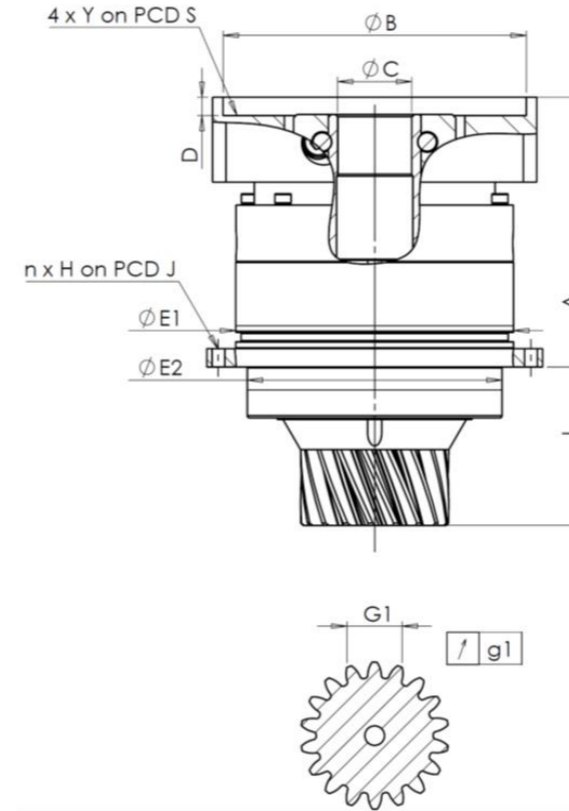

For the installation, please refer to User Manual KRP (182/008)

SPECIFIC REMARKS:

General tolerance: Js13 Cmm Automatic / manual coordinate-measuring machine µm Micrometer Cr Calliper rule Di Dial indicator Pg Plug gauge

HOUSING					OUTPUT PINION					MOTOR FLANGE				
requirement		measure			requirement		measure			requirement		measure		
G2406					G1444									
Ø	E1	120h7 ⁰ _{-0,035}	µm	119,99	Span dimension over 3 teeth					Ø	B	111	µm	111
Ø	E2	110h7 ⁰ _{-0,035}	µm	109,99	G1	23,466 ^{-0,071} _{-0,082}	Cmm	23,389	Ø	C	24 ^{+0,041} _{+0,02}	µm	24,02	
n x H on PCD J		8Ø5,5 on PCD 135	Cr	8Ø5,5 on PCD 135	g1	0,021	Di	0,01	Ø	D	8	Cr	8,45	
					No-load input torque					Ø	S1	130	Cr	130
A	117,5	µm	117,74	Line 1					0,2 Nm	Ø	Y1	M8	Pg	M8
L	69	µm	69,35											

Noise level			
	Line	Stiffness	1600 rpm input (dB(A))
Torsional stiffness (Nm/arcmin)	1	40	64,0
Radial stiffness (N/µm)	1	160	

Date: **22/04/2024**

Visa: **C DE MIRANDA**

Version: **A**

Product images are for illustrative purposes only.