

CUSTOMER: **POWERCOR** CUSTOMER ORDER REF: ***33686-00 POWERCOR**
 DISTRIBUTOR: **REDEX ORDER REF: 218249**
 DESIGNATION: **KRP1+M.10.3.H.28/38** SERIAL NUMBER: **908309**
 CODE: **RX129833-03** MOTOR FLANGE CODE: **RX129461-01**

EXTERNAL DIMENSIONS & INTERFACES: SN: **908309**

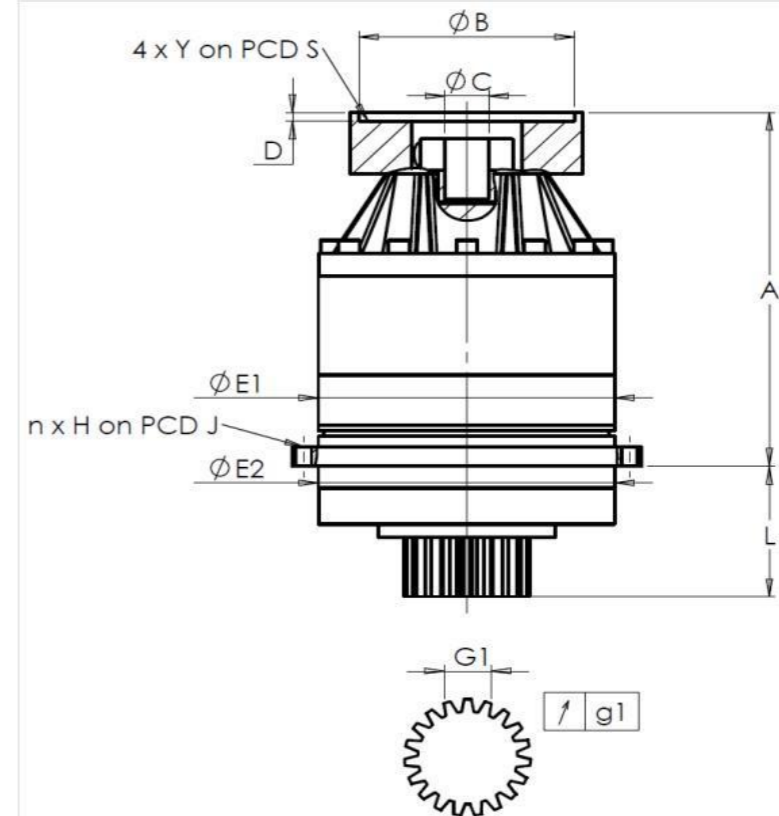

For the installation, please refer to User Manual KRP (182/008)

SPECIFIC REMARKS:

General tolerance: Js13 Cmm Automatic / manual coordinate-measuring machine µm Micrometer Cr Calliper rule Di Dial indicator Pg Plug gauge

HOUSING				OUTPUT PINION				MOTOR FLANGE				
requirement		measure		requirement		measure		requirement		measure		
		G1955				F22						
E1	152h7 ⁰ _{-0,04} µm	151,98	Span dimension over 3 teeth				Ø B	131 µm	131			
E2	140h7 ⁰ _{-0,04} µm	139,98	G1	23,28 ⁰ _{-0,03} Cmm	23,265	Ø C	32 ^{+0,05} _{+0,025} µm	32,03				
n x H on PCD J	12 Ø6,5 on PCD 168 Cr	12 Ø6,5 on PCD 168 Cr	g1	0,021 Di	0,01	Ø D	5 Cr	5,5	Ø S1	165 Cr	165	
A	202 µm	202,75	No-load input torque				Ø Y1	M10 Pg	M10			
L	71 µm	70,7	Line 1		0,4 Nm							

		Line	Stiffness	Noise level	
				@1600 rpm input (dB(A))	65,0
Torsional stiffness (Nm/arcmin)	1	81,39			
Radial stiffness (N/µm)	1	305			

Date: **12/01/2024**

Visa: **C DE MIRANDA**

Version: **A**

Product images are for illustrative purposes only.