

CUSTOMER: FERROCAM CUSTOMER ORDER REF: *390 CON 676 FERROCAM
 DISTRIBUTOR: ANDANTEX S.r.l REDEX ORDER REF: 217932
 DESIGNATION: KRP0+R.10.4.143H.V1/B5 SERIAL NUMBER: 908023
 CODE: RX135896-03 MOTOR FLANGE CODE: RX129627-02

EXTERNAL DIMENSIONS & INTERFACES: SN: 908023

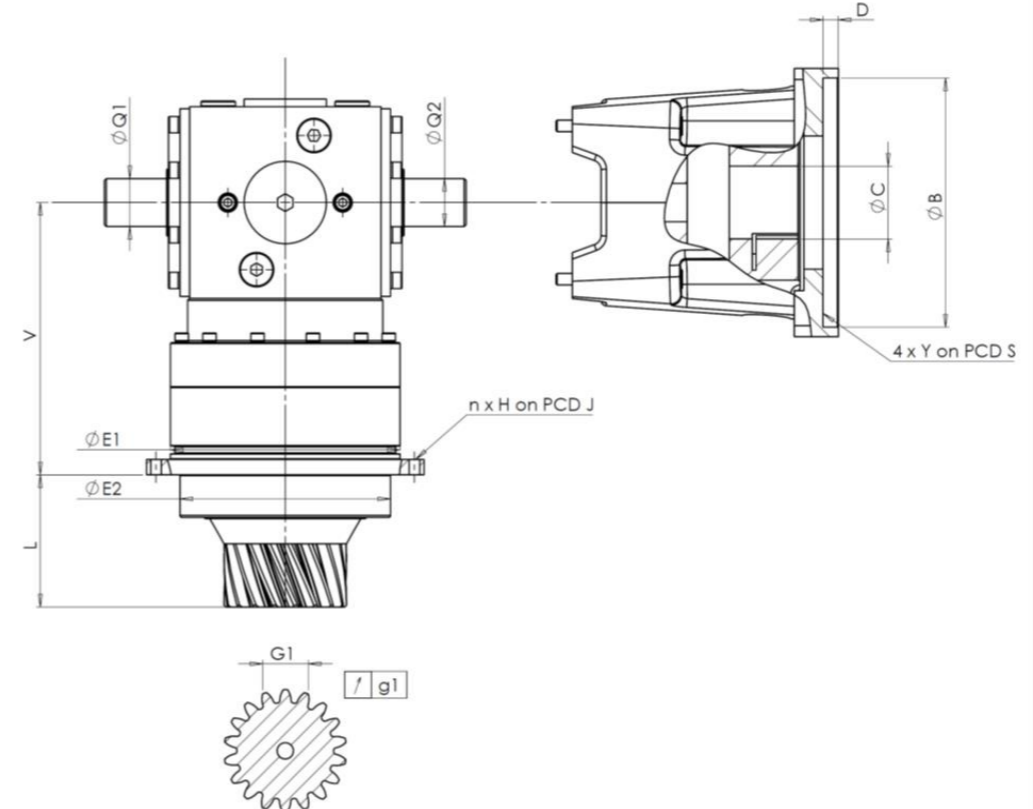

For the installation, please refer to User Manual KRP (182/008)

SPECIFIC REMARKS:

General tolerance: Js13 Cmm Automatic / manual coordinate-measuring machine µm Micrometer Cr Calliper rule Di Dial indicator Pg Plug gauge

HOUSING				OUTPUT PINION				MOTOR FLANGE					
requirement		measure		requirement		measure		requirement		measure			
		H1943				G1443				F6112			
Ø	E1	120h7 ⁰ _{-0,035}	µm	119,98	Span dimension over 3 teeth				Ø	B	114,3 ^{+0,047} _{+0,012}	µm	114,325
Ø	E2	110h7 ⁰ _{-0,035}	µm	109,99	G1	23,466 ^{-0,071} _{-0,082}	Cmm	23,385	Ø	C	35 ^{+0,05} _{+0,025}	µm	35,025
n x H on PCD J		8Ø5,5 on PCD 135		Cr	8Ø5,5 on PCD 135		Di	0,01	Ø	D	8	Cr	8,1
V		142		µm	142,1		No-load input torque						
L		69		µm	69,31		Line 1		0,2 Nm		Noise level		
Ø	Q1	25 ^{+0,009} _{-0,004}	µm	25,001			Line	Stiffness	1600 rpm input (dB(A))		65,0		
Ø	Q2	25 ^{+0,009} _{-0,004}	µm	25,002			Torsional stiffness (Nm/arcmin)		1		40		
								Radial stiffness (N/µm)		1		160	

Date: 26/10/2023

Visa: C DE MIRANDA

Version: A

Product images are for illustrative purposes only.