

CUSTOMER: **BLANCO** CUSTOMER ORDER REF: ***4050011954 BLANCO**
 DISTRIBUTOR: **REDEX GmbH** REDEX ORDER REF: **217211**
 DESIGNATION: **KRP0+R.10.2.183H.V1/B5** SERIAL NUMBER: **907214**
 CODE: **RX134685-03** MOTOR FLANGE CODE: **RX129506-04**

EXTERNAL DIMENSIONS & INTERFACES: SN: **907214**

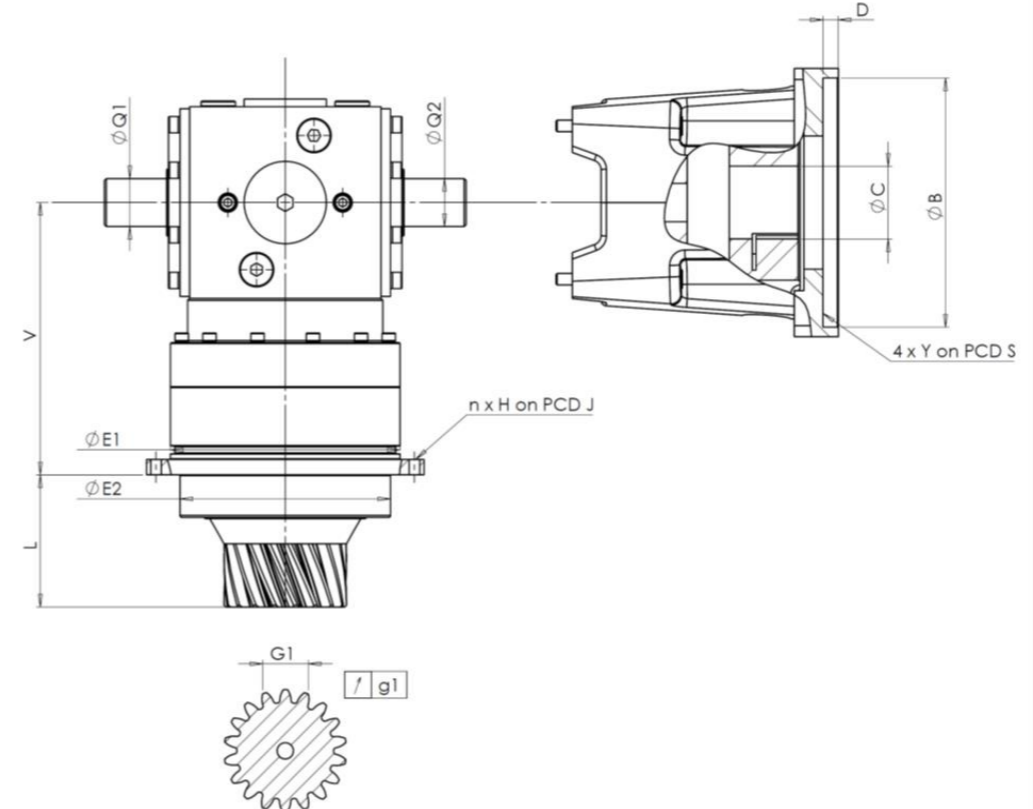

For the installation, please refer to User Manual KRP (182/008)

SPECIFIC REMARKS:

General tolerance: Js13 Cmm Automatic / manual coordinate-measuring machine µm Micrometer Cr Calliper rule Di Dial indicator Pg Plug gauge

HOUSING				OUTPUT PINION				MOTOR FLANGE					
requirement		measure		requirement		measure		requirement		measure			
		H949				L1016				F3642			
Ø	E1	120h7 ⁰ _{-0,035}	µm	119,98	Span dimension over 3 teeth				Ø	B	110 ^{+0,047} _{+0,012}	µm	110,03
Ø	E2	110h7 ⁰ _{-0,035}	µm	109,98	G1	23,278 ⁰ _{-0,023}	Cmm	23,275	Ø	C	24 ^{+0,041} _{+0,02}	µm	24,04
n x H on PCD J		8Ø5,5 on PCD 135	Cr	8Ø5,5 on PCD 135	g1	0,021	Di	0,02	Ø	D	8	Cr	8,09
V		142	µm	142,17	No-load input torque				Ø	S1	130	Cr	130
L		69	µm	69,33	Line 1		0,4 Nm		Ø	Y1	M8	Pg	M8
Ø	Q1	25 ^{+0,009} _{-0,004}	µm	25,008	Noise level				1600 rpm input (dB(A))		65,5		
Ø	Q2	25 ^{+0,009} _{-0,004}	µm	25,008	Line		Stiffness						
						Torsional stiffness (Nm/arcmin)		1		40			
						Radial stiffness (N/µm)		1		160			

Date: **20/01/2023** Visa: **C DE MIRANDA**
 Version: **A**

Product images are for illustrative purposes only.



1, Rue Paul De Fontenay
 F- 45210 FERRIERES
 www.redex-group.com

Tel: +33 2 38 94 42 00
 Fax: +33 2 38 94 42 99
 Email: info@redex-group.com



1, Rue Paul De Fontenay
 F- 45210 FERRIERES
 www.redex-group.com

Tel: +33 2 38 94 42 00
 Fax: +33 2 38 94 42 99
 Email: info@redex-group.com