

CUSTOMER: **IBARMIA** CUSTOMER ORDER REF: ***009221/116885 IBARMIA**
 DISTRIBUTOR: **REDEX ORDER REF: 217122**
 DESIGNATION: **KRP0+R.10.4.143H.V3/B5** SERIAL NUMBER: **907172**
 CODE: **RX134666-03** MOTOR FLANGE CODE:

EXTERNAL DIMENSIONS & INTERFACES: SN: **907172**

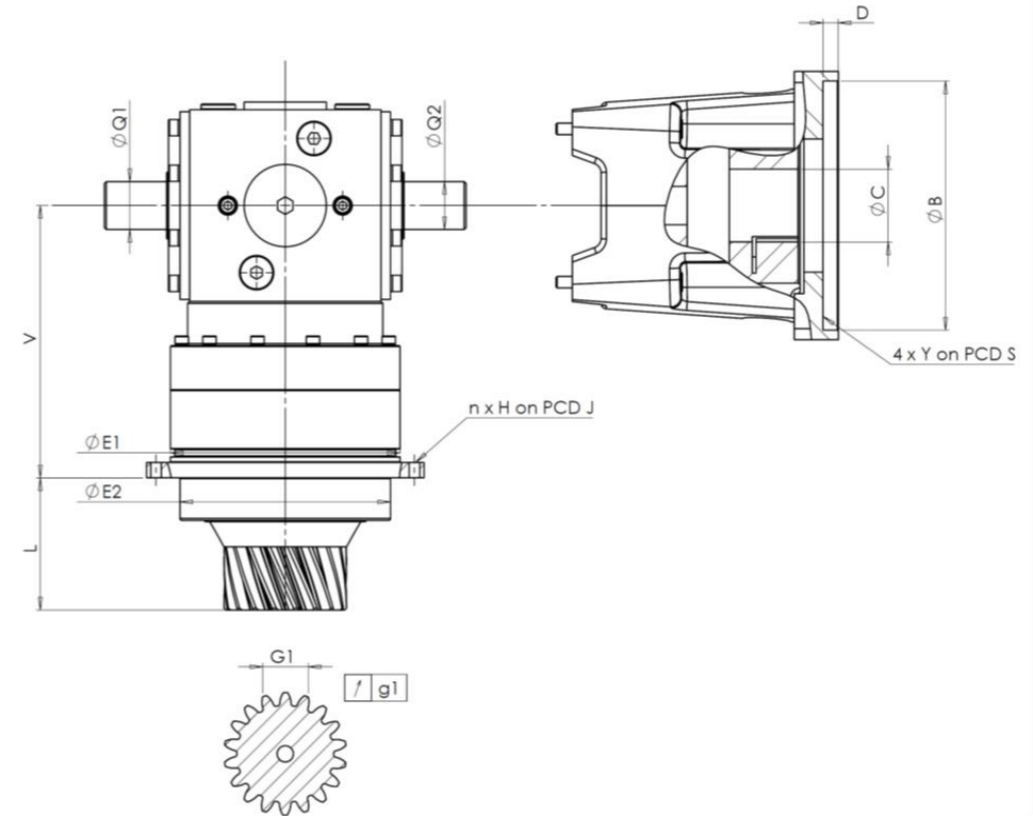

For the installation, please refer to User Manual KRP (182/008)

SPECIFIC REMARKS:

General tolerance: Js13 Cmm Automatic / manual coordinate-measuring machine µm Micrometer Cr Calliper rule Di Dial indicator Pg Plug gauge

HOUSING				OUTPUT PINION				MOTOR FLANGE				
requirement		measure		requirement		measure		requirement		measure		
		H968				K2534						
Ø	E1	120h7 ⁰ _{-0,035}	µm	119,99	Span dimension over 3 teeth				Ø	B	µm	
Ø	E2	110h7 ⁰ _{-0,035}	µm	109,99	G1	23,466 ^{-0,071} _{-0,082}	Cmm	23,39	Ø	C	µm	
n x H on PCD J		8Ø5,5 on PCD 135	Cr	8Ø5,5 on PCD 135	g1	0,021	Di	0,02	Ø	D	Cr	
				No-load input torque				Ø S1				
V		142	µm	142,15	Line 1				Ø Y1			
L		69	µm	69,27					Noise level			
Ø	Q1	25 ^{+0,009} _{-0,004}	µm	25,005			Line	Stiffness	1600 rpm input (dB(A))		65,5	
Ø	Q2	25 ^{+0,009} _{-0,004}	µm	25,005								
				Torsional stiffness (Nm/arcmin)		1	40					
				Radial stiffness (N/µm)		1	160					

Date: **06/01/2023**

Visa: **C DE MIRANDA**

Version: **A**

Product images are for illustrative purposes only.