

CUSTOMER: **MAKA** CUSTOMER ORDER REF: **\*514222 MAKA**  
 DISTRIBUTOR: **REDEX GmbH** REDEX ORDER REF: **217014**  
 DESIGNATION: **KRP0+M.10.3.183H.V1.22/32** SERIAL NUMBER: **906955**  
 CODE: **RX134402-03** MOTOR FLANGE CODE: **RX128707-05**

EXTERNAL DIMENSIONS & INTERFACES: SN: **906955**

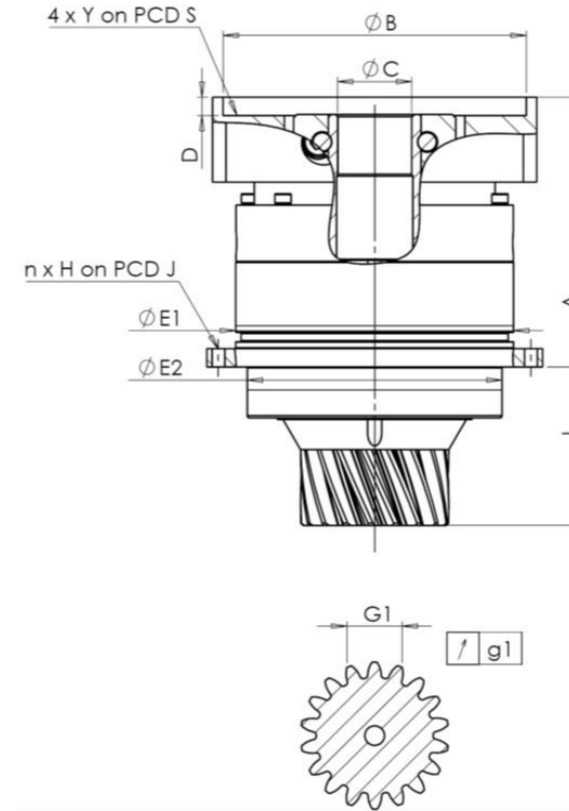

General tolerance: Js13 *Cmm* Automatic / manual coordinate-measuring machine  $\mu\text{m}$  Micrometer *Cr* Calliper rule *Di* Dial indicator *Pg* Plug gauge

For the installation, please refer to User Manual KRP (182/008)

SPECIFIC REMARKS:

HOUSING					OUTPUT PINION				MOTOR FLANGE				
requirement		measure			requirement		measure		requirement		measure		
		J3184					L1029						
Ø	E1	120h7 <sup>0</sup> <sub>-0,035</sub>	$\mu\text{m}$	119,98	Span dimension over 3 teeth				Ø	B	131	$\mu\text{m}$	131
Ø	E2	110h7 <sup>0</sup> <sub>-0,035</sub>	$\mu\text{m}$	109,98	G1	23,278 <sup>0</sup> <sub>-0,023</sub>	<i>Cmm</i>	23,275	Ø	C	32 <sup>+0,05</sup> <sub>+0,025</sub>	$\mu\text{m}$	32,03
n x H on PCD J		8Ø5,5 on PCD 135	<i>Cr</i>	8Ø5,5 on PCD 135	g1	0,021	<i>Di</i>	0,02	Ø	D	8	<i>Cr</i>	8,52
		A	$\mu\text{m}$	117,8	No-load input torque				Ø	S1	165	<i>Cr</i>	165
		L	$\mu\text{m}$	69,25	Line 1		0,2 Nm		Ø	Y1	M10	<i>Pg</i>	M10

Noise level			
	Line	Stiffness	1600 rpm input (dB(A))
Torsional stiffness (Nm/arcmin)	1	40	60,0
Radial stiffness (N/ $\mu\text{m}$ )	1	160	

Date: **08/09/2022**

Visa: **C DE MIRANDA**

Version: **A**

Product images are for illustrative purposes only.